

## PUDU SH1 Wallchart

# Preparations



Fully charge the battery, before the first use.



Press battery Indicator button(A) , check the battery state.



Align the fully charged battery with the bottom groove, push forward till fixed.



Hold the side splash guard, align with the two holes of the chassis, push forward till fixed.



Hold the disc brush, align the brush center with the silver disc center, rotate the L brush rapidly clockwise and the R brush rapidly counterclockwise, until the brush is fixed on the silver disc.



Check the vacuum hose tightly connected to the squeegee. Insert the vacuum hose to the suction port, rotate the vacuum hose 1/4 turn clockwise until securely fixed.



Hold the chassis firmly with one hand, hold the squeegee with another hand, align with the pin on the chassis, push one side and another of the squeegee in place.



Fill the solution tank and add low foaming detergent.



Put the solution tank to the groove, push forward to the main body.



Place the recovery tank downwards.

## PUDU SH1 Wallchart

# Quick start guide



Press and hold the power switch(A) for 3 seconds to power on the machine.



Swipe the screen with the finger, click to select the cleaning mode.



Press either side of the operation button(B) to start the operation.  
\*The button can be customized in settings.



Control the direction and push the machine forward to start clean.



Hold the lift handles on both sides of the squeegee, lift up once to raise the squeegee, lift up again to put down the squeegee.



The machine must be in parking position when maintain it, transport it by wheels, or lift it by hands.



The machine need to be folded and fixed when in storage.



## PUDU SH1 Wallchart

# Posture switch

Use posture switch ring and multi-functional shaft to switch the position



### Working position

Parking position switch to working position: lift and pull the posture switch ring once, lift up the pin, unlock the shaft, switch to the working position.



### Parking position

Working position switch to parking position: lift and pull the posture switch ring again, put down the pin, turn to the groove till the pin inserted, hear the click sound, lock the shaft, switch to the parking position.



### Store position

Working position switch to storing position: lift and pull the posture switch ring once, lift up the pin, unlock the shaft, then put down the main body, pull the posture switch ring again, put down the pin, turn to the groove till the pin inserted, lift up the machine and switch to the storing position.





# PUDU SH1 Wallchart

## Maintenance



Step the release pedal, hold the recovery tank handle, lift the recovery tank upwards.



Pull out the rubber cap of recovery tank, empty the tank.



Remove the recovery tank window cover and use fresh water to clean it. Use the water gun to rinse the inside of the recovery tank, then pour out the dirty water.

\*The filter box is optional.



Unlock the 4 buckles, open and clean the upper recovery tank.

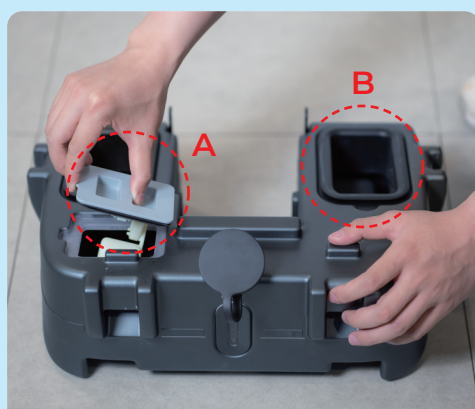

Remove floater A and rubber sealing ring B and use fresh water to clean it. (Clean once a week).



Align the silver metal hook C into the right position, put down the upper part, lock the 4 buckles.



Press the unlock button (D), pull out the solution tank from main body.



Use the fresh water clean the solution tank. shake several times to rinse off the detergent left in the tank.



Hold the disc brush, rotate the L brush rapidly counterclockwise and the R brush rapidly clockwise, until the brush get loosen.

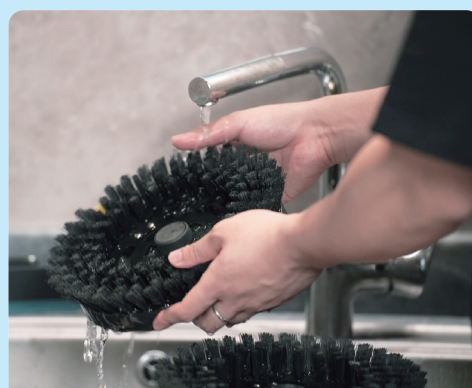

Use fresh water and detergent to clean the brushes.



Hold the chassis firmly with one hand, hold the squeegee with another hand, pull out one side and another from the pins on the chassis. Rotate the vacuum hose 1/4 turn counterclockwise until loosen it.



Use fresh water and detergent to clean the vacuum hose and squeegee.



# PUDU SH1 Wallchart

## Troubleshooting



| Poor water recovery:                                      |   | Insufficient/no water flow:                 |  | No power:                  |                              |
|---|---|---|--|----------------------------|------------------------------|
| Cause   | Solution  | Cause                                       | Solution   | Cause                      | Solution                     |
| Squeegee is raised  | Lower the squeegee  | Empty Solution tank                         | Fill the solution tank                                   | No battery                 | Insert battery               |
| Squeegee rubber blades is worn out                        | Replace rubber blades   | Solution tank not in place                  | Reinstall  | Battery incorrectly placed | Remove and reinstall battery |
| Squeegee blocked  | Check and remove blockage, ensure that the squeegee fits the ground | Filter blocked                              | Clean the solution tank outlet                           | Empty battery              | Charge battery               |
| Squeegee is not connecting well with squeegee vacuum hose | Reinstall   | Dirt in the solution tank                   | Clean solution tank                                      |                            |                              |
| Vacuum hose blocked                                       | Check and remove blockage   | The mode used is no water or low water flow | Use mode like heavy duty, normal, ECO, low residue, soak |                            |                              |
| Recovery Tank is not installed properly                   | Reinstall   |   |  |                            |                              |
| Recovery Tank top not tightly covered                     | Close it tightly  |   |  |                            |                              |
| Recovery Tank Filter jammed                               | Clean the Recovery Tank Filter                                      |   |  |                            |                              |



PUDU SH1  
Operation Guide



PUDU SH1  
Software User Manual